

Ground Floor
42.0sqm
Total Floor Area 84m²

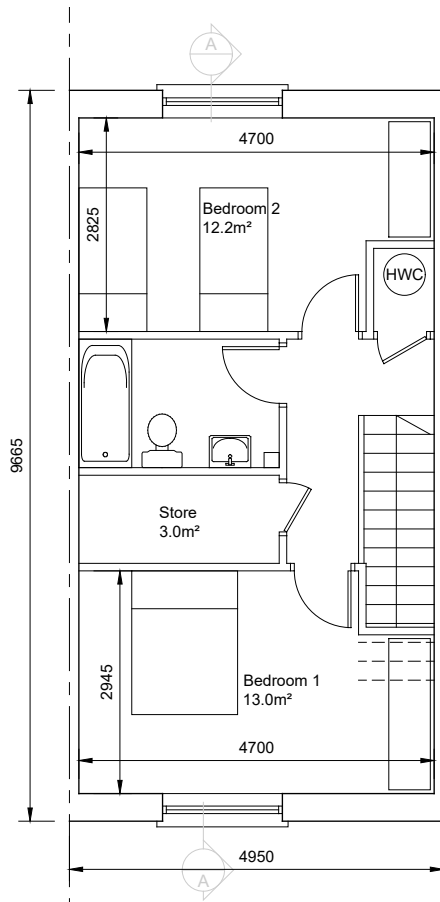

First Floor
42.0sqm



FRONT ELEVATION



REAR ELEVATION

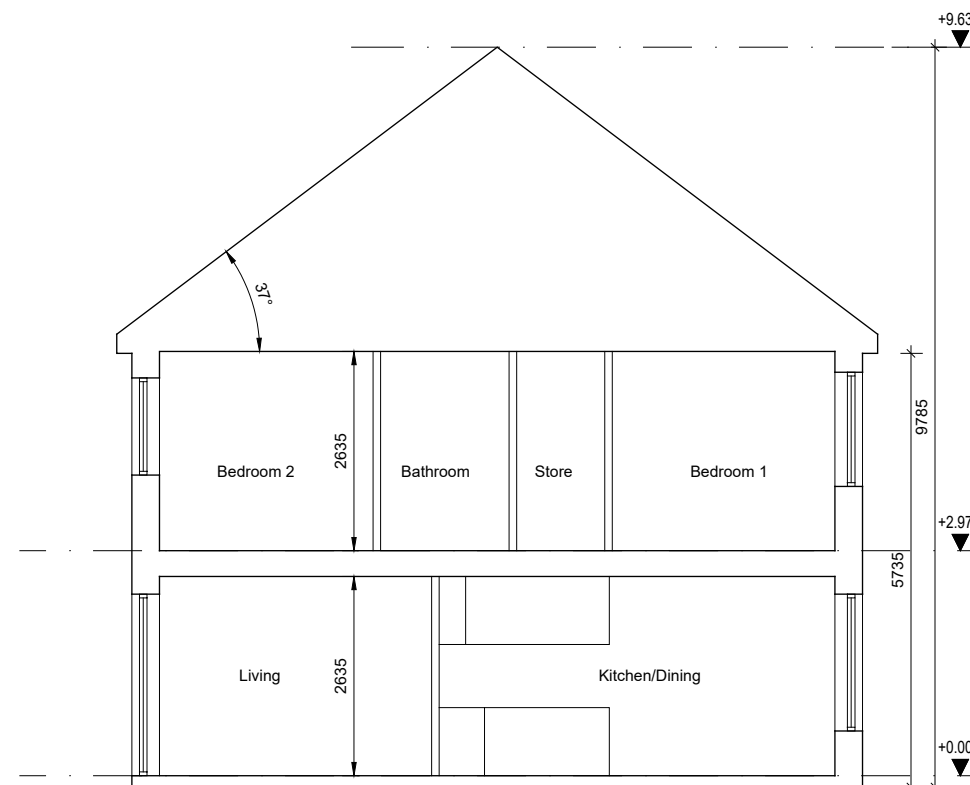

SECTION A-A

- © This drawing is copyright.
 1 Do not scale this drawing.
 2 Errors and omissions to be immediately notified to Architect.
 3 All dimensions to be checked on site.
 4 To be read with relevant Engineers drawings.

Notes:

- All dimensions in millimetres.
- North point orientation / levels as per site plan.
- This Housetype may be handed. See site layout plan.

External Finishes:

Roof:
Fibre-cement slates.

Walls:
Painted render finish
Selected facing brick

Windows:
uPVC or timber framed

Gutters/downpipes:
uPVC or aluminium

Front Door:
Selected coloured composite or painted timber door with fanlight and/or sidelight and/or glazed light in leaf

revisions	date	inls
description		
HOUSETYPE N7		drawing no. 1828 P N7-100
PLANS, ELEVATIONS & SECTION		scale 100@A3
Development at Academy Street Navan		date NOV '19
client		drawn PMV
COINDALE LTD.		checked MC
issue		
PLANNING		
CONROY CROWE KELLY ARCHITECTS & URBAN DESIGNERS 65 MERRION SQUARE DUBLIN 2 phone 01 6613990 fax 01 6765715 email info@cck.ie		